

State of Alabama, Chilton County

I hereby certify that the within

Dec. 20, 1939

M., and

map

41 and

J. Lee Smith

# HOYET BROWNIE

Addition To The City of Clanton, Chilton  
County, State of Alabama.

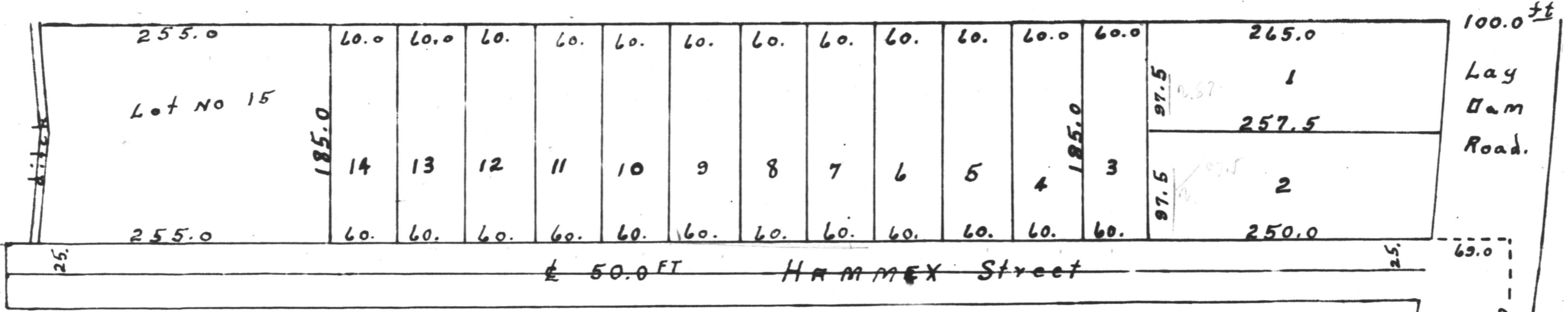
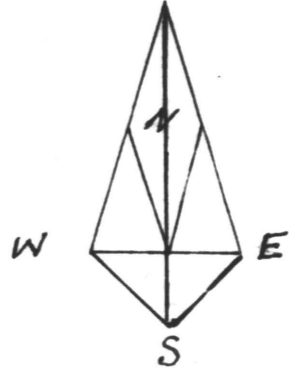

I - G. E. RUSH COUNTY SURVEYOR CHILTON COUNTY - And  
W. A. REYNOLDS OWNER, Do Hereby Certify That All  
Information Shown Hereon Is True And Correct.

W. A. Reynolds  
OWNER

Date 12-20-39.

Scale 1" = 100.0 FT

G. E. Rush  
Registered County Surveyor.

STATE OF ALABAMA  
CHILTON COUNTY

Before me, Lillian C. Smith, a Notary Public in and for said County and for said County Surveyor, and W. A. Reynolds, owner, whose names are signed to the map and certificate hereon, and who are known to me, acknowledged before on this day, that being informed of the contents of said map and certificate, they signed the same voluntarily on the day the same bears date.

Given under my hand and seal, this the 20th day of December, 1939.  
Lillian C. Smith, Notary Public.