

PROPERTY OF MRS. JOE S. GREEN -Deed

Eighteen (18) acres, more or less, in SW 1/4 of SE 1/4, Sec. 9, T 21, Range 13, lying north of the Clanton and Maplesville State Highway and being that 18 acres which touches and is directly north of said highway and being east of the Isabella and Clanton road. Also that part of the SE 1/4 of the SE 1/4 of Sec. 9, T 21, Range 13 lying north of the Clanton and Maplesville Highway containing 18 acres more or less and containing in the aggregate, 36 acres more or less.

CAUTION OF ABSTRACT

All that part of the SE 1/4 of the SE 1/4 lying north of the Clanton and Maplesville Highway, also 28 acres, more or less, North of the Clanton and Maplesville Highway, less 10 acres across the north side of the SW 1/4 of the SE 1/4 of Sec. 9, T 21, R 13 containing 36 acres more or less.

Field Survey

Beginning at the NE Cor. of the NE 1/4 of the SE 1/4, Sec. 9, T 21, R 13, which point is an established corner and running in a southerly direction 1333.5 feet along section line to NE Cor. of the SE 1/4 of the SE 1/4 of Sec. 9, T-21, R-13 to point of beginning of property being surveyed. Thence from point thus established a line along Section line in a southerly direction to intersection with Alabama State Highway right of way. Also beginning at the NE 1/4 of the SE 1/4, Sec. 9, T-21, R-13 and running in a westerly direction for a distance of 1333.5 to the NW Cor. of the SE 1/4 of the SE 1/4, Sec. 9, T-21, R-13, thence in a southerly direction 330.0 feet, thence in a westerly direction to a point intersecting the Isabella and Clanton Road.

The above description of Field Survey has been completed by Engineers Inc. and is true and correct to the best of our knowledge and belief.

M. H. Smith
Pres. Engineers Inc.

W. C. Folk

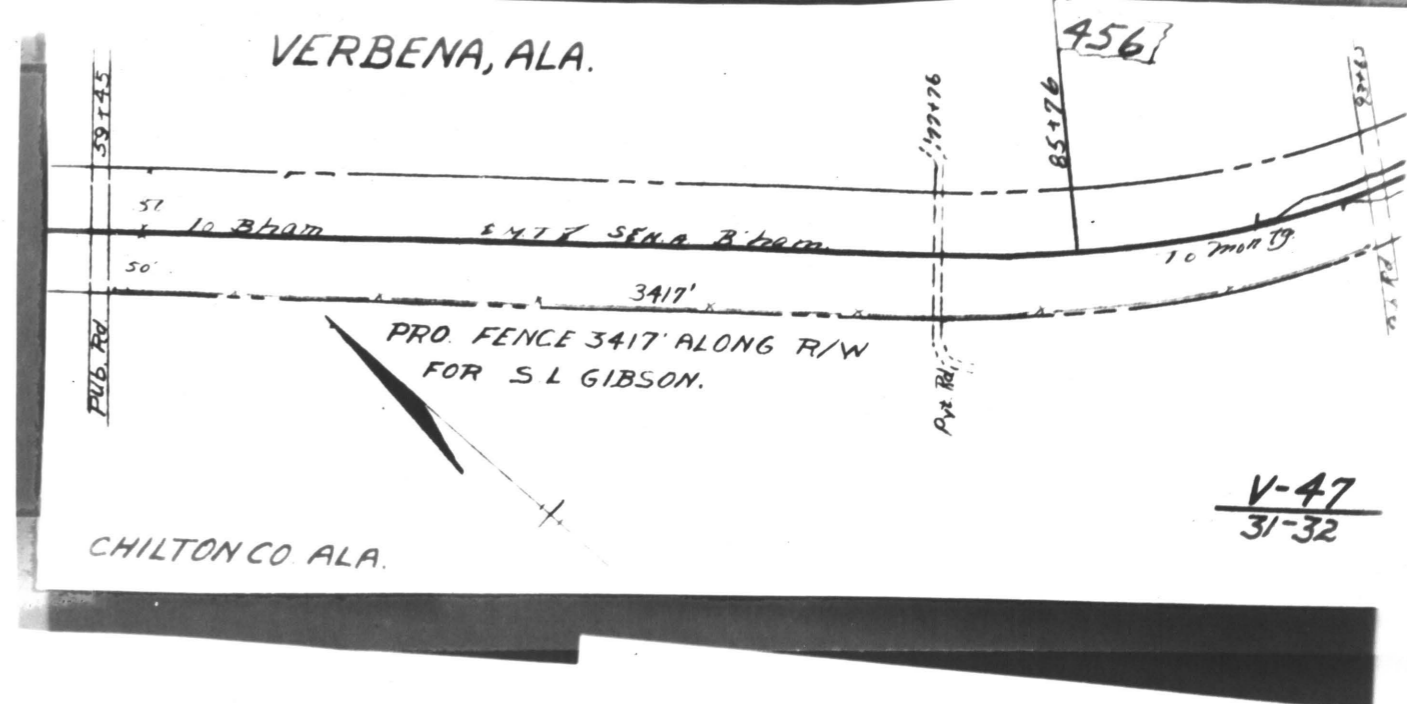

V-47
31-32