

RIGHT OF WAY MAP  
 S-781(2) REVISED  
 CHILTON COUNTY  
 SCALE 1" = 200'

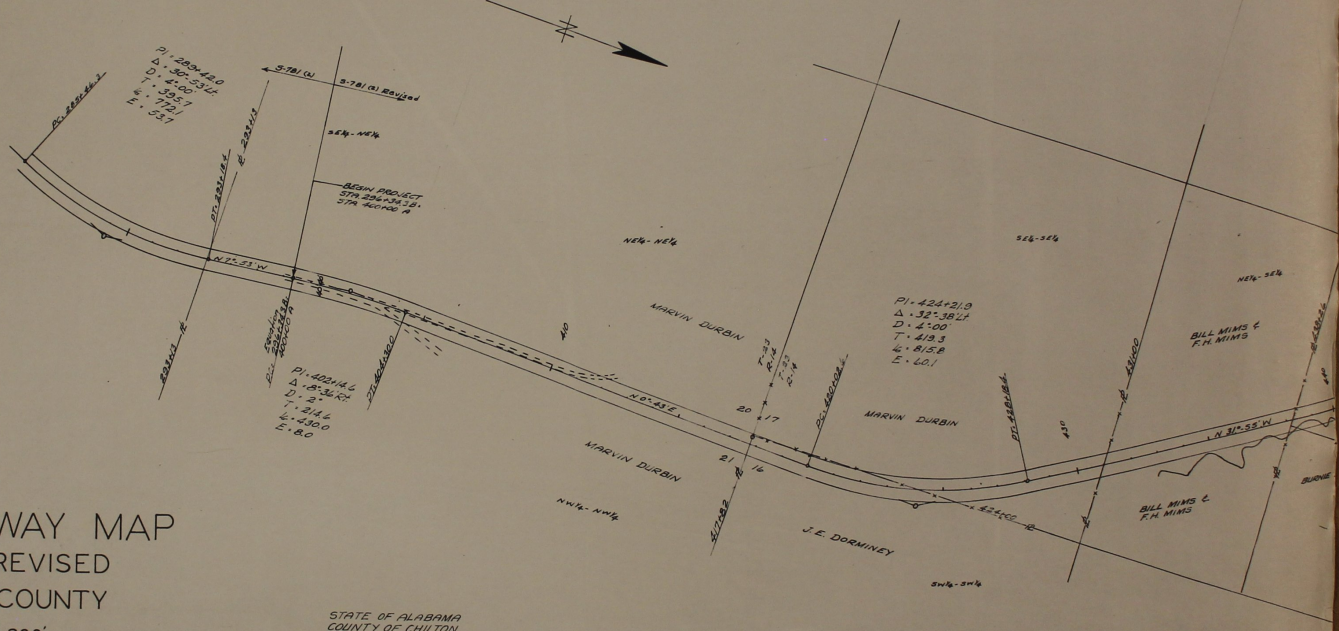

STATE OF ALABAMA  
 COUNTY OF CHILTON

I, H.J. Lewis, a Registered Engineer and Land Surveyor of Chilton County, Alabama, hereby certify that the foregoing is a true and correct map of Road Project S-781(2), revised, located in Chilton County, Alabama.

*H. J. Lewis*  
 Registered Engineer & Land Surveyor

a1