

EXISTING UNPAVED CO. RD.  
TO CLANTON REPAIR ROAD

TO HIGGINS FERRY ROAD

180N PIN  
ROUND  
NW COR. NE 1/4 - NE 1/4  
S-32 T-22 R-15E

NOTE: EXISTING ROADS AROUND SUBJECT PROPERTY HAVE NO SET R.O.W.  
PROPERTY NECESSARY TO GIVE 50' IS TAKEN FROM SUBJECT PROPERTY.

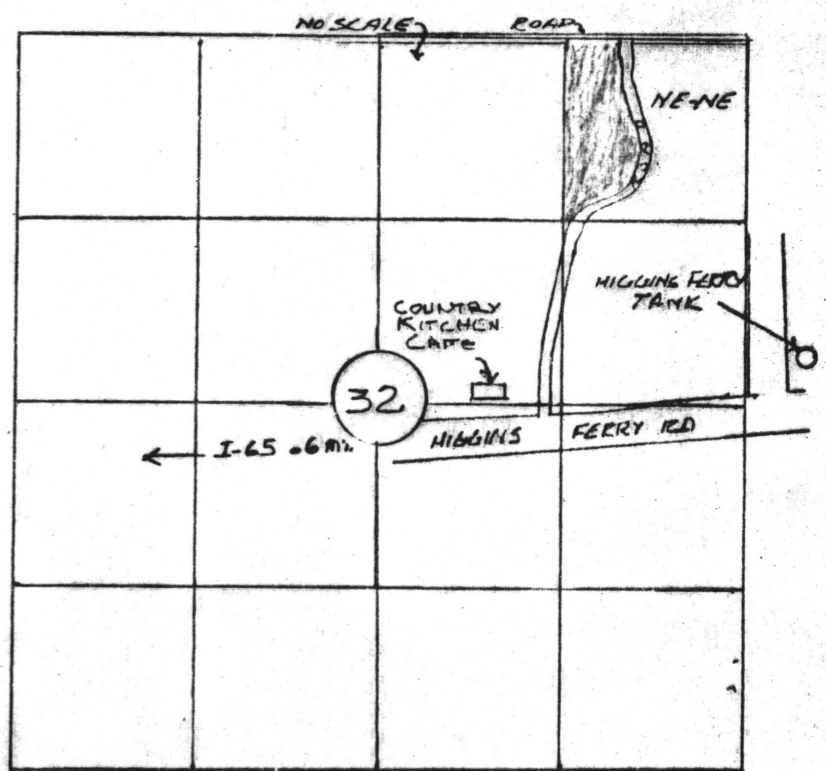
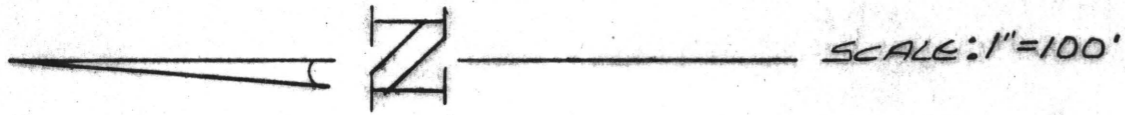

STATE OF ALABAMA  
COUNTY OF CHILTON

I, JOHN H. MARCUS, HEREBY CERTIFY THAT I AM THE OWNER OF THE WITHIN PROPERTY AND THAT I DID ENGAGE HARVEY ATKINSON, A COMPETENT REGISTERED LAND SURVEYOR TO SUBDIVIDE SAID PROPERTY, AND I DO HEREBY ADOPT THIS PLAN OF SUBDIVISION OF MY OWN FREE WILL, AND I DO HEREBY DEDICATE ALL STREET RIGHTS OF WAYS AND OTHER PUBLIC SPACES AS NOTED HEREON, IF ANY.

*John H. Marcus*  
John H. Marcus, OWNER

STATE OF ALABAMA  
COUNTY OF CHILTON

I, Barbara Langston, A NOTARY PUBLIC IN AND FOR SAID COUNTY AND STATE HEREBY CERTIFY THAT JOHN H. MARCUS, WHOSE NAME IS SIGNED TO THE FOREGOING PLAT, AND WHO IS KNOWN TO ME, APPEARED BEFORE ME, AND ACKNOWLEDGED THAT ON BEING INFORMED OF THE CONTENTS OF THE SAME, DID EXECUTE THE SAME VOLUNTARILY ON THE DAY THE SAME BEARS DATE. GIVEN UNDER MY HAND AND SEAL, THIS THE 1<sup>st</sup> DAY OF February, 1972.

*Barbara Langston*  
NOTARY PUBLIC

APPROVED: *C.C. Gay, Jr.* DATE: 1-31-72  
C.C. GAY, JR. SANITARIAN  
CHILTON COUNTY HEALTH DEPT.

STATE OF ALA. CHILTON CO.  
I CERTIFY THIS  
INSTRUMENT IS CORRECT

1973 FEB -1 AM 9:51

U.C.C. FILE NUMBER OR  
REC. BK. & PAGE AS SHOWN ABOVE

*Harvey Atkinson*  
REGISTERED LAND SURVEYOR

Map Book 4 Page 170

STATE OF ALABAMA  
COUNTY OF CHILTON

I, HARVEY ATKINSON, A REGISTERED LAND SURVEYOR, HEREBY CERTIFY THAT THE FOREGOING IS A TRUE AND CORRECT MAP OF THE WITHIN DESCRIBED PROPERTY, TO WIT: FROM THE NW CORNER OF THE NE 1/4 - NE 1/4, S-32, T-22 N, R-15E, CHILTON COUNTY, ALA., RUN SOUTH ALONG THE WEST LINE OF SAID 40 ACRE TRACT FOR 7 FEET TO THE POINT OF BEGINNING OF SUBJECT PROPERTY; CONTINUE THENCE ALONG SAID LINE FOR 1266.5 TO THE NORTHEASTLY CORNER OF A PUBLIC ROAD; RUN THENCE ALONG SAID R.O.W. OF SAID ROAD 11625.6' TO A POINT WHERE SAID LINE INTERSECTS THE SOUTH R.O.W. LINE OF A COUNTY ROAD; RUN THENCE WESTERLY ALONG SAID LINE FOR 4710 FEET BACK TO THE P.O.B. CONTAINING 13.5 ACRES, MORE OR LESS. I FURTHER CERTIFY THAT I HAVE ESTABLISHED ALL LOT LINES AND STREET RIGHTS OF WAY, AND HAVE SHOWN THEIR LENGTHS AND BEARINGS AND THEIR RELATION TO THE ORIGINAL GOVERNMENT SURVEY.

ACCORDING TO MY SURVEY THIS THE 20<sup>th</sup> DAY OF SEPTEMBER, 1972

*Harvey Atkinson*  
HARVEY ATKINSON, REG. L.S.  
ALA. REG. NO. 6852

HIGHRISE ESTATES  
SUBDIVISION  
CHILTON COUNTY  
ALABAMA  
NE-NE-S-32 T-22 N R-15E

PREPARED BY:  
GENERAL SURVEYS CO.  
P.O. Box 1215  
CLANTON, ALA. 35045